

Sterling Park

APARTMENTS

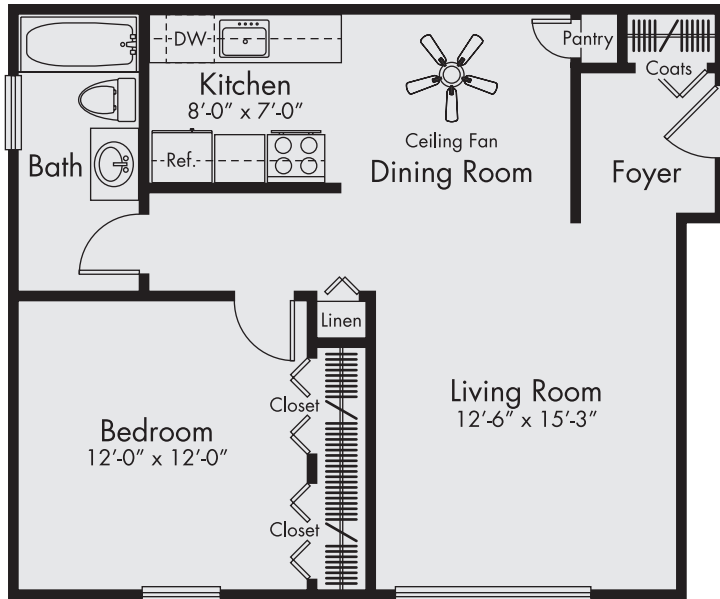

THE GRANDVILLE SECOND FLOOR

1 Bedroom // 1 Bath // Approx. 625 sf

The Grandville's entry foyer and guest closet lead to a large living room and adjoining dining room located off a galley kitchen, complete with modern appliances. The bedroom offers abundant storage space with double closets and convenient access to the central bath.

8348 18 Mile Road // Sterling Heights, Michigan 48313 // 586.268.5151 // SterlingPark@maill.com // Sterling-Park.com

We reserve the right to modify features, price, specifications and/or to change or discontinue models without notice or obligation. Floor plan dimensions are approximate. All information provided herein is subject to change at ownership's sole discretion. 060418

